



Mr J Poole
Latham's Steel Doors Australia
Unit 2, 868 Beaufort St
Inglewood WA 6052

RSA-200502-CE-S-003
19 February 2021

Dear John,

Subject: Region D Certification of "Container Window Shutter"

RSA Pty Ltd certifies that the door indicated above and pictured overleaf is suitable for use as an external door in Region D, as per AS/NZS 1170.2:2011.

The door has been subject to – and passed – the following tests conducted by RSA:

- Static pressure test up to 4.2kPa
- Timber member impact test as per Section 2.5.8 of AS/NZS 1170.2:2011
- 8mm steel ball impact test as per Section 2.5.8 of AS/NZS 1170.2:2011

The below design parameters were considered in assessing the door. They are typical for standard use.

Property	Symbol	Value	Notes
Regional wind speed	V_R	88 m/s	Region D, Importance Level 2, 50-year design life
Wind direction multiplier	M_d	1	
Terrain/Height multiplier	$M_{z,cat}$	0.91	Terrain Category 2, door not above 5m elevation
Shielding multiplier	M_s	1	No shielding from buildings assumed
Topographic multiplier	M_t	1	Relatively flat ground assumed
Internal pressure coefficient	$C_{p,i}$	-0.3	No dominant opening

Please contact this office for advice if design parameters are to differ from those given above.

Sincerely,

Michael Cassie BSc MPE (Dist) GradIEAust
Structural Engineer

Tristan Salter BEng (Hons) MIEAust CPEng NER
Civil and Structural Engineer

Anti-Vandal Window Shutter



**Concealed
Shoot Bolts**



Handle



Glazing



Threshold

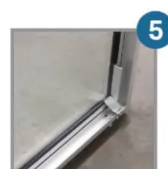

**Glazing
Locks**

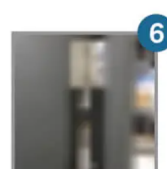

**Hinges &
Dog Bolts**

Featuring Genuine HOOPLY® Multi-Point Locking System

Figure 1: Container Window Shutter tested by RSA