



## Overview

### Size (mm)

External Frame	720, 820, 920, 1020 & 1120 x 2050 Leaf (790, 890, 990, 1090 & 1190 x 2095 Frame)
----------------	--

### Finish

White powder coat from stock

### Frame Extensions

Expanding Side Panels	+5-40mm, +50-85mm
-----------------------	-------------------

Overhead Panels	+25-300mm
-----------------	-----------

## Security Front Door & Frame

Our security front doors have been designed to provide customers with added peace of mind while also maintaining the home's aesthetic.

With a range of personalisation & security options, including a choice of glazing, door furniture and a range of colours, you can tailor your door to your requirements.

Available in a range of stock sizes



### Door Leaf

Door Depth	50mm Thickness
Material & Gauge	1.0mm Galvanised Steel
Insulation	Mineral Wool Insulation
Int. Strengthening	Internal Reinforcement Bars
Door Seal	Nylon Self Adhesive V-Seal

### Door Frame

Frame Depth	90mm Depth
Material & Gauge	1.8mm Galvanised Steel
Frame Seal	Nylon Self Adhesive V-Seal
Fixing Points	10 Fixing Points
Insulation	Mineral Wool Insulation

### Hinge

Hinge Qty & Type	4 Stainless Steel Ball Bearing
Anti-Jemmy Studs	4 pcs

### Lock

Main Lock	Genuine ST8 HOOPLY™ Lock
Top & Bottom Locks	3 Shoot Bolts Top & Bottom
Euro Cylinder	UAP Standard Trade Lock
Side Locks	Genuine HOOPLY™ Side Locks

### Acoustic & Thermal

Acoustic Value	35dB
U Value	2.20W/m2.k

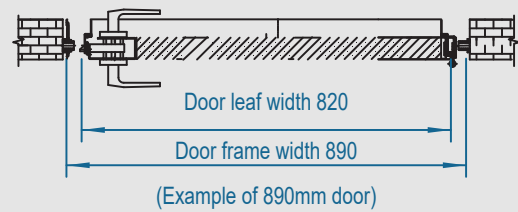
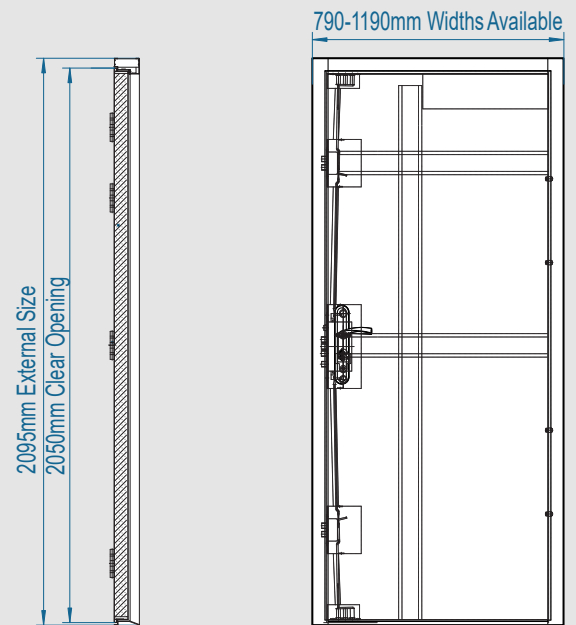

Designed to provide a simple & effective way to protect your property at an affordable price, our Security Front Doors are easy to install and will offer extra peace of mind when it comes to securing your home.

Available in a choice of stock sizes and finished with a heavy duty Surf-mist polyester powder coat, we also have a range of frame extensions to help bridge the gap between your opening and our sizes.

With security in mind, these steel doors are fitted with our industry-leading 19 point locking system. Manufactured from a thick gauge steel, with a dense mineral wool core, draught proof seals & 4 stainless steel ball bearing hinges, they are suitable for any climate.

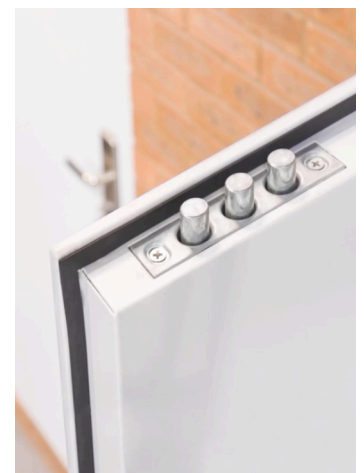
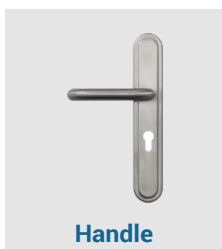
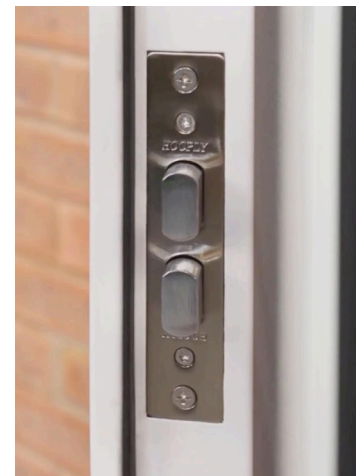

For more information please visit our website:  
[www.lathamsteeldoors.com.au](http://www.lathamsteeldoors.com.au) or give us a call on +61 415 310 911